

NOTES:

- ALL WORK IN ACCORDANCE WITH THE RELEVANT SECTIONS OF SANS 1200 AND AS REQUIRED BY THE LOCAL AUTHORITIES OR STATUTORY BODIES.
- WHERE REFERENCE IS MADE TO THE SOUTH AFRICAN STANDARD SPECIFICATIONS, THE CURRENT EDITION SHALL BE USED.
- REFER TO ARCHITECTS LAYOUTS FOR SETTING OUT INFORMATION.
- ALL DIMENSIONS AND LEVELS TO BE CHECKED ON SITE PRIOR TO CONSTRUCTION, ANY DISCREPANCIES SHOULD BE REPORTED TO THE ENGINEER IMMEDIATELY.
- ONLY WRITTEN DIMENSIONS AND LEVELS SHALL BE USED.
- THIS DRAWING TO BE READ IN CONJUNCTION WITH DRAWINGS FROM THE RELEVANT DISCIPLINES.
- THE CONTRACTOR SHALL GIVE THE ENGINEER AT LEAST 24 HOURS ADVANCE NOTICE FOR INSPECTIONS.
- THE ENGINEER SHALL BE NOTIFIED WITHOUT DELAY SHOULD THERE BE ANY DISCREPANCIES BETWEEN DRAWINGS, DETAILS AND SPECIFICATIONS.
- FOUNDATION EXCAVATIONS TO BE INSPECTED AND APPROVED BY THE STRUCTURAL / GEOTECHNICAL ENGINEER BEFORE ANY BLINDING IS COMPLETED.
- ALL DIMENSIONS AND LEVELS TO BE CHECKED BY THE ENGINEER PRIOR TO CASTING CONCRETE.
- ALL DUCTS OR RECESSES TO BE APPROVED BY THE ENGINEER.
- POSITION OF CONSTRUCTION JOINTS TO BE APPROVED BY THE ENGINEER.
- CONCRETE STRENGTHS @ 28 DAYS:
BLINDING : 15 MPa
FOUNDATIONS : 25 MPa
COLUMNS : 30 MPa
SURFACE BEDS : 25 MPa
ROOF SLABS : 30 MPa
BEAMS : 30 MPa
- COVER TO STEEL REINFORCEMENT: U.O.N.
FOUNDATIONS : 50 mm
COLUMNS : 30 mm
BEAMS : 30 mm
- ALL SHARP EXPOSED EDGES TO BE CHAMFERED 20 x 20mm.
- ALL WATERPROOFING TO ARCHITECTS DETAIL.
- SAW CUTS ARE TO BE MADE AS SOON AS THE CONCRETE IS FIRM ENOUGH NOT TO BE TORN OR DAMAGED BY THE CUTTING BLADE (USUALLY BETWEEN 24 TO 48 HOURS AFTER CASTING).
- ALL STEELWORK TO BE FABRICATED AND ERECTED IN ACCORDANCE WITH SANS 2001-C01 & SANS 1921-3.
- ALL STEELWORK TO BE SANS 50025-S355JR UNLESS OTHERWISE NOTED.
- ALL DIMENSIONS TO BE SET IN SHOP DRAWINGS SHALL BE SUBMITTED TO THE ENGINEER FOR APPROVAL BEFORE FABRICATION COMMENCES.
- ALL WELDS TO BE MINIMUM 6mm CONTINUOUS FILLET WELDS UNLESS OTHERWISE NOTED AND IN STRICT ACCORDANCE WITH SANS AND ANSIA/WS STANDARDS.
- ALL BOLTS SHALL BE GRADE 8.8 UNLESS OTHERWISE NOTED.
- ALL STEELWORK TO BE HOT DIPPED GALVANISED TO SANS 1200-HC AND SANS 121 UNLESS OTHERWISE NOTED.

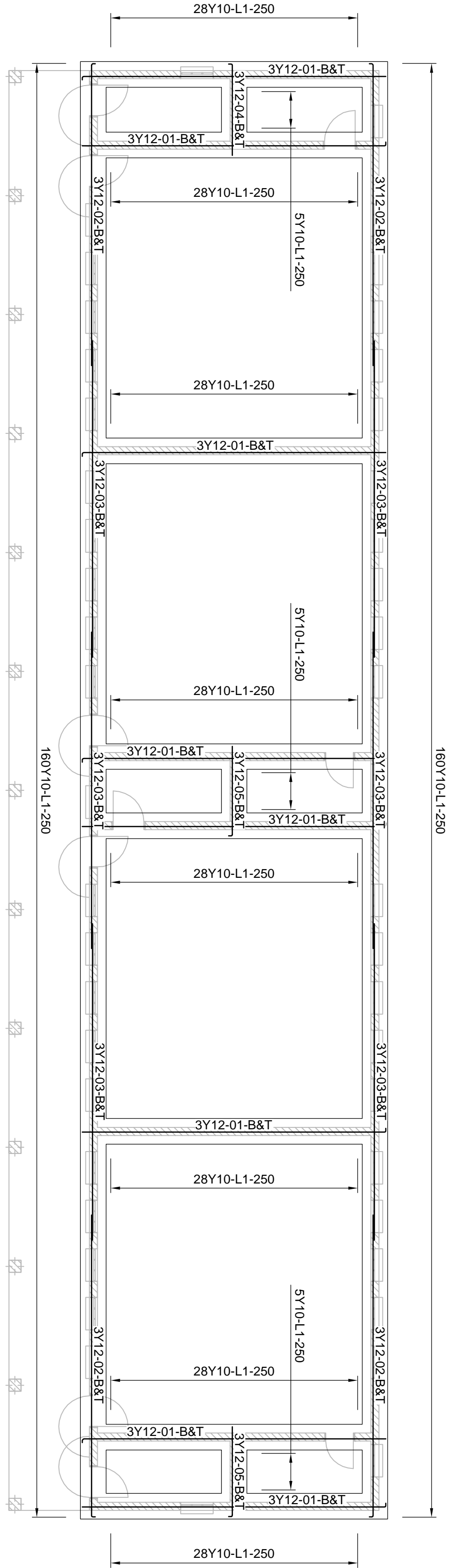

SINGLE STOREY 4 CLASSROOM BLOCK: FOUNDATION REBAR LAYOUT
SCALE 1:100



PROJECT
DBSA SCHOOLS R9
THAKAMESO COMPREHENSIVE SECONDARY SCHOOL
FREE STATE

DRAWING

SINGLE STOREY 4 CLASSROOM BLOCK
FOUNDATION REBAR LAYOUT

RESPONSIBLE PERSON		DATE
DESIGNED	MG	2022-11-29
DRAWN	SR	2022-11-29
CHECKED	MG	2022-11-30
APPROVED	MANI GOVENDER (PR. ENG. - 20080241)	2022-11-30
SCALE	AS SHOWN	SHEET SIZE A1
PROJECT NUMBER DRAWING NUMBER STATUS REVISION		

SAB1777-TCSS-371-C-00

DRAWING STATUS CODES :

R = REBAR
D = DRAWN
T = DESIGNER
P = PRELIMINARY
C = CONSTRUCTION
A = AS BUILT

COPYRIGHT RESERVED